



Side screen

markilux 790

Ideal, lateral protection against low-lying sun,
light wind and inquisitive glances.

Product characteristics



face fixture bracket for the front profile with angle for lateral fixture ¹⁾



docking post with welded base plate



docking post incl. ground sleeve



safety mechanism for the handle fitted to the docking post



mobifix: docking post fitted to a granite baseplate ¹⁾



docking bracket for front profile fitted to a railing



docking bracket for front profile fitted to a free-standing post or markilux pergola / pergola compact



detail at the top: pivoting option to fit the cassette to a free-standing post ¹⁾

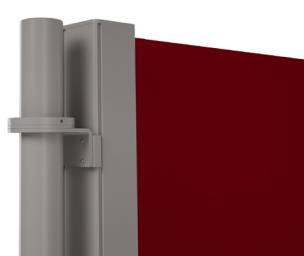

detail at the bottom: free-standing post with swivelling holders for the cassette ¹⁾

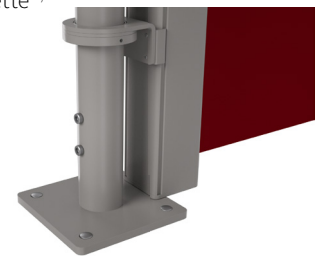

¹⁾ Optional accessories

Product characteristics

Description

- the discretely shaped side screen giving allround protection to the cover thanks to the satisfactory, square cassette.

Special features

- the height of the grip on the front profile can be adjusted to the exact conditions on site – so that the front profile can be locked in position and the cover tension adjusted without a problem
- the pre-set tension in the spring mechanism can be adjusted on site to comply with the wishes of the customer
- the screen cover can be cut diagonally to order, in which case the front profile will be correspondingly shorter – giving perfect protection in combination with a markilux folding-arm awning or markilux pergola classic / cubic / compact (only for version with rigid columns)
- intermediate screen heights and a good choice of fixture options are available – to make them employable on a patio, a balcony or even free standing
- docking post for the front profile with integrated safety lock for the grip to prevent it being released inadvertently

Dimensions

- awning in the standard version 173 cm / 213 cm / 250 cm in height
- extension: 200–450 cm (depending on the screen height and fabric pattern)
- intermediate sizes are available

Roller tube and lateral bearings

- round roller tube Ø 63 mm with keyway, galvanised steel, with integrated, maintenance-free spring mechanism providing optimum cover tension
- the roller tube bearing is made of machine finished, rolled aluminium

Awning profiles

- extruded aluminium, in façade quality, powder coated
- cassette profile in one piece, 95 mm × 95 mm
- circular front profile Ø 32 mm

Side caps

- end caps are made of high-quality plastic, dyed through or powder coated – at the spring end they are aluminium, powder coated
- the front profile end caps are made of high-quality plastic, dyed through in RAL 7035 or similar anthracite metallic 5204 (depending on the awning frame colour)

Fixture brackets

- cassette brackets for face or reveal fixture, fixture to a rigid post (free standing or to the post of the markilux pergola classic / cubic / compact / markilux syncra)
- brackets for the front profile: face fixture, docking post with ground sleeve / base plate for bolting down, mobilfix (mobile docking post on a base plate), brackets for fixture to a (balcony) railing
- grip for front profile made of high-quality plastic, dyed through in RAL 7035 or similar anthracite metallic 5204 (depending on the awning frame colour)

Frame colours

markilux frame colours without surcharge

traffic white, RAL 9016



metallic aluminium, RAL 9006

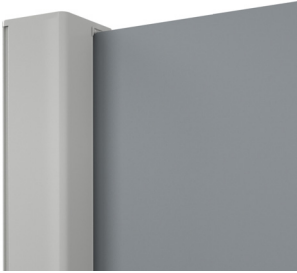

grey brown, similar to RAL 8019

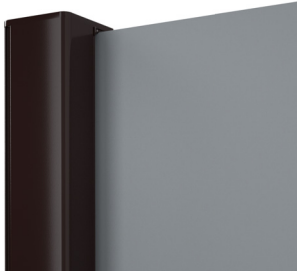

off-white textured finish, 5233 ¹⁾

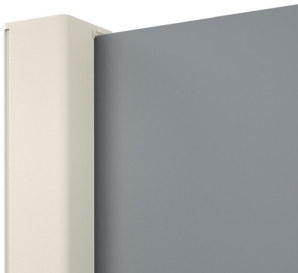

stone grey metallic, 5215 ¹⁾



anthracite metallic, 5204 ¹⁾



havana brown textured finish, 5229 ¹⁾

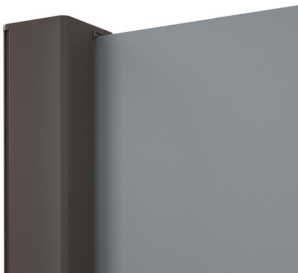

Non-standard powder-coated finish

Bespoke frame colours incur a surcharge – matt, metallic, finely textured and pearl finishes as well as other colour ranges (DB, Tiger etc.) on request. All frame colours are available at a surcharge with enhanced corrosion protection.

Colours may differ slightly from those depicted in both hue and finish.

Note on the colour of the visible plastic parts

White and grey frame colours: visible plastic parts in light grey RAL 7035.

Other frame colours: visible plastic parts similar to anthracite metallic 5204.

Frame colour: stone grey metallic 5215 ¹⁾

Visible plastic parts: light grey RAL 7035



Frame colour: anthracite metallic 5204 ¹⁾

Visible plastic parts: similar to anthracite metallic 5204 ¹⁾



¹⁾ textured finish

Dimensions and configuration options

Single unit

| | | Extension | | | | |
|------------------|-------------------|-----------|-----|-----|-----|-------------------|
| | | 250 | 300 | 350 | 400 | 450 ¹⁾ |
| Order dimensions | | 200 | 251 | 301 | 351 | 401 |
| | | 250 | 300 | 350 | 400 | 450 |
| GH | 173 ²⁾ | | | | | |
| | 213 | | | | | — |
| | 250 | | | | | — |

dimensions in cm

1) = angled top edge not possible

2) = minimum height 90 cm

GH = overall height (cassette height + 30 mm)
intermediate sizes are available at surcharge

| | |
|--|-------------------------------|
| | = cover height approx. 162 cm |
| | = cover height approx. 202 cm |
| | = cover height approx. 239 cm |

Operation

| | standard | optional |
|-------------------------|----------|----------|
| manual extension | ✓ | — |
| cover exit to the right | ✓ | — |
| cover exit to the left | — | ✓ |

Awning cover

| | fabric pattern no. | standard | optional | extension | tailored cloth |
|----------------------------|-----------------------|----------|----------|----------------------|----------------|
| sunvas | 300..–315.. | ✓ | — | | SN |
| sunsilk | 324.. / 328.. / 369.. | ✓ | — | | SN |
| sunbow | 411..–427.. | ✓ | — | ≤ 300 | SN |
| vuscreen Alu ¹⁾ | 317.. | — | ✓ | ≤ 240 > 241 ≤ 300 | N SN |
| transolair | 338.. | — | ✓ | ≤ 240 > 241 | N SN |
| transolair (120 cm) | 339.. | — | ✓ | | SN |

dimensions in cm

N = Seamless

SN = vertical seam, panel width 120 cm

1) Only possible up to a total height of 213 cm

Fixture options

| | |
|--|--------|
| Face fixture bracket 50 mm | 78758. |
| wall docking option | 77822. |
| docking bracket for front profile with clamp for fixture to a railing Ø 40-45 mm | 77984. |
| docking bracket for front profile with clamp for fixture to a railing Ø 45-50 mm | 77985. |
| docking bracket for front profile with clamp for fixture to a railing Ø 40-50 mm | 62433. |
| docking post with welded footplate 950 mm | 77820. |
| docking post with ground sleeve 950 mm | 77821. |

Fixture options

| | |
|--|--------|
| cassette bracket for reveal fixture 50 mm | 77845. |
| angled bracket for lateral face fixture 175 × 60 × 60 mm | 77987. |
| free-standing post 1730–1830 mm Ø 70 mm with footplate for cassette fixture | 71175. |
| brackets for fixture of the cassette to the markilux pergola classic / cubic / compact | 71174. |
| bracket for fixture of the front profile to a post Ø 70 mm | 71136. |
| brackets for fixture of the cassette to a square post of the markilux syncra | 72231. |
| brackets for fixture of the cassette to a round post of the markilux syncra | 72208. |
| mobilfix granite including docking post | 778211 |

Dimension overview, cover with diagonally cut top edge

Please give the dimensions indicated when ordering

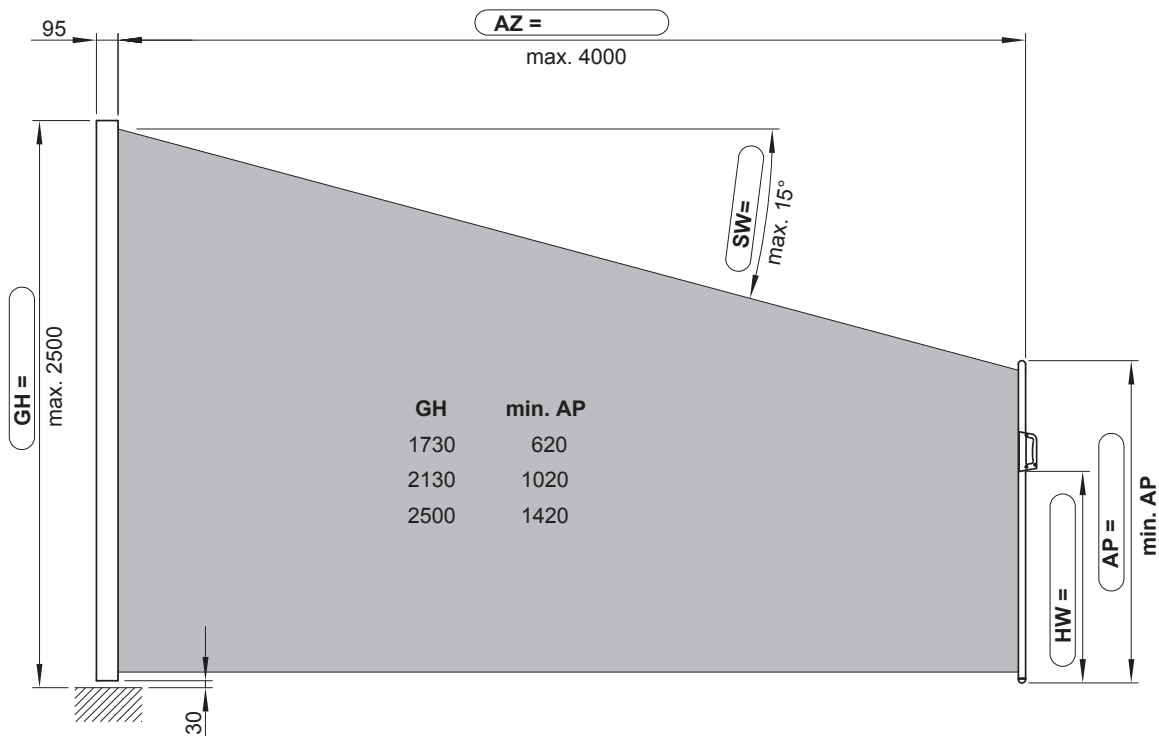

- AP = height of the front profile
- AZ = **order measurement** = extension
- GH = **order measurement** = overall height side screen
- HW = height of the wall docking bracket
- SW = angle of the top edge of the cover

dimensions in mm

Dimension overview, standard cover

Docking post with welded bottom plate, ground sleeve or face fixture bracket

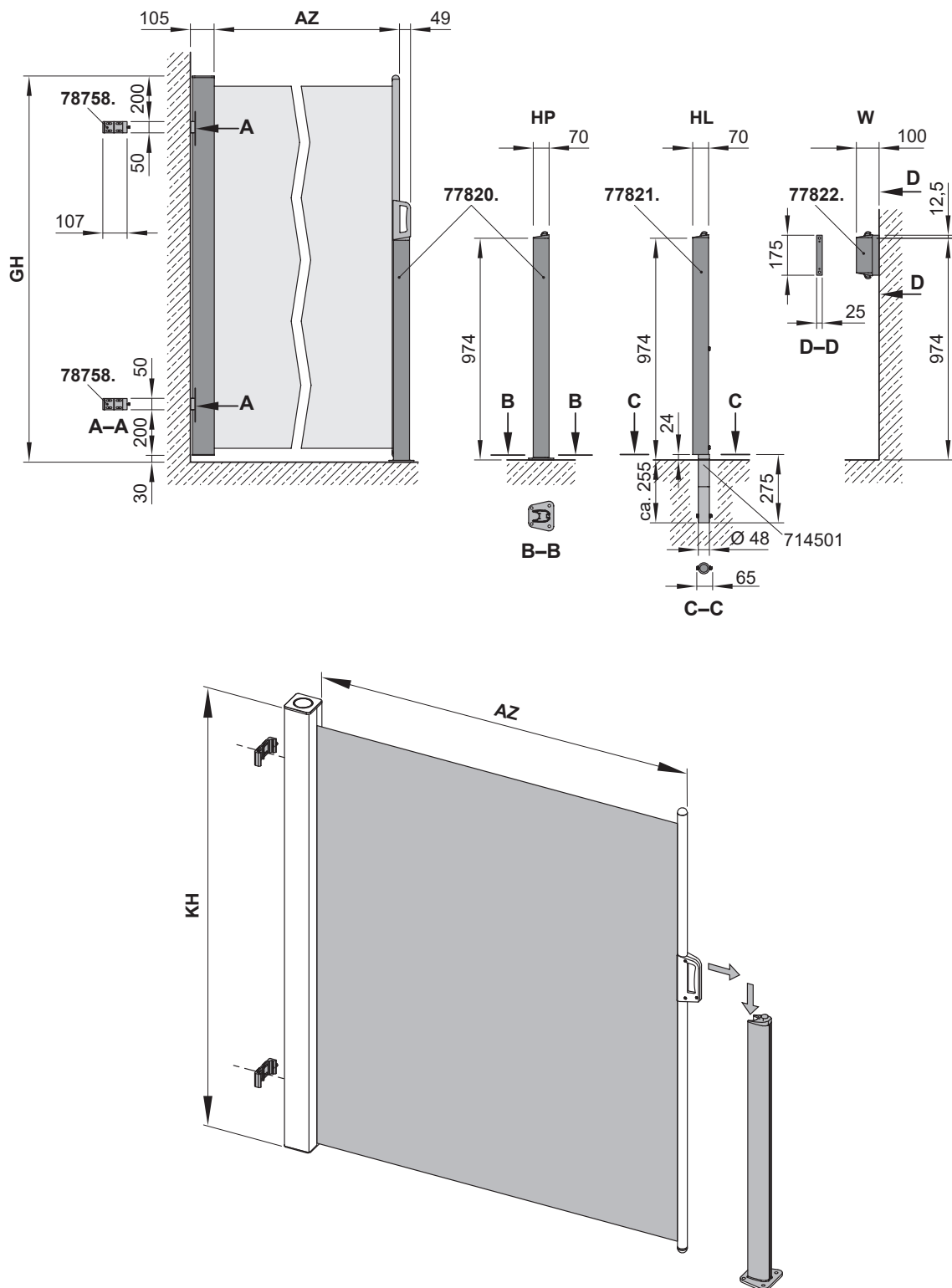

714501 = ground sleeve
77820 = sleeve assembly for insertion in the ground
77821 = docking post for tension profile for ground sleeve
77822 = face fixture bracket for tension profile
78758 = face fixture bracket 50 mm

AZ = order measurement = extension
GH = order measurement = overall height side screen
HL = sleeve assembly for insertion in the ground
HP = docking post for fixture to solid surface
KH = cassette height = $GH - 30$ mm
W = face fixture

dimensions in mm

Face fixture, face fixture bracket for the cassette

Fixtures, fittings and accessories

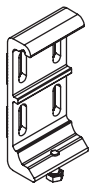

face fixture bracket
50 mm

78758.

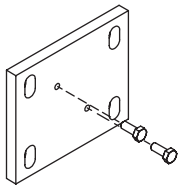

spreader plate
120 × 100 × 10 mm

78982.

Cover exit to the right standard (see figure) – cover exit to the left optional

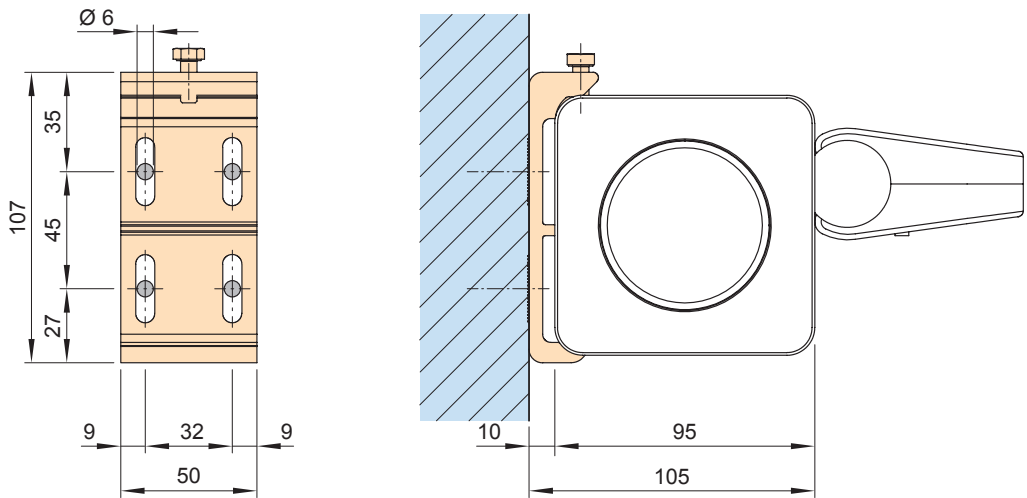

Spreader plate for the face fixture bracket

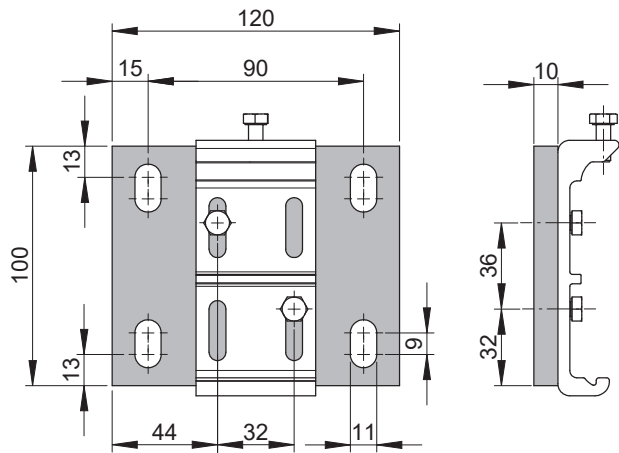

dimensions in mm

Face fixture, face fixture bracket for the cassette

Fixtures, fittings and accessories

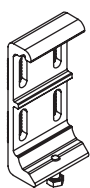

face fixture bracket
50 mm

78758.

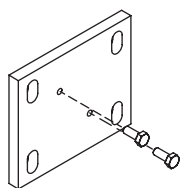

spreader plate
120 × 100 × 10 mm

78982.

Cross section view with face fixture bracket for the front profile

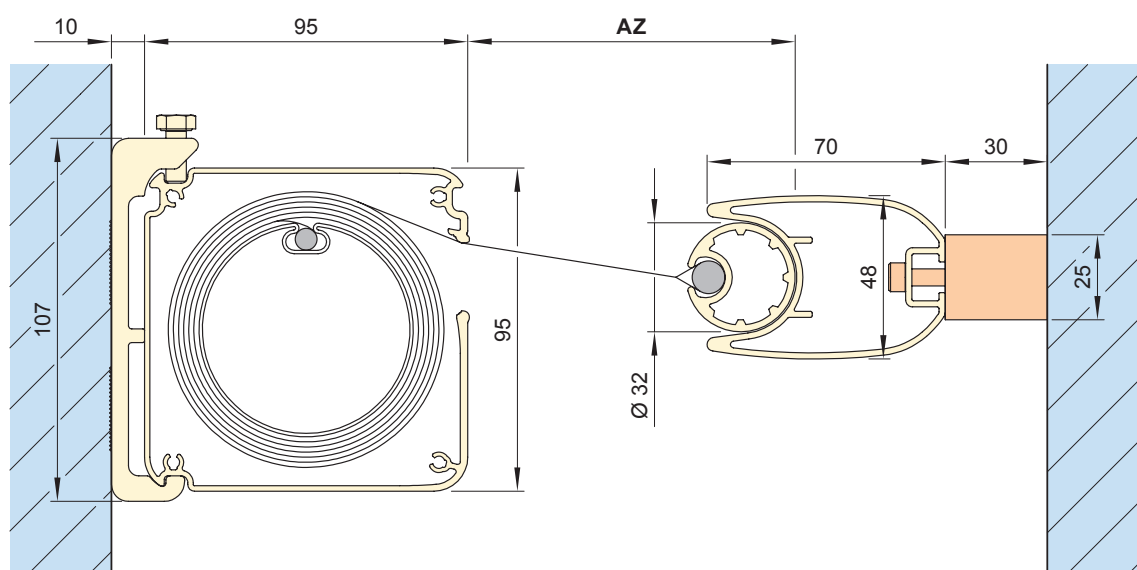

Face fixture, face fixture bracket for the front profile

Fixtures, fittings and accessories

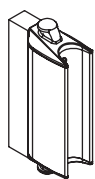

face fixture bracket
assembly for the front
profile

77822.

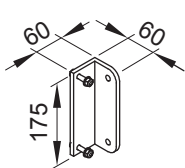

angled bracket for
lateral face fixture
77822.
175 × 60 × 60 mm

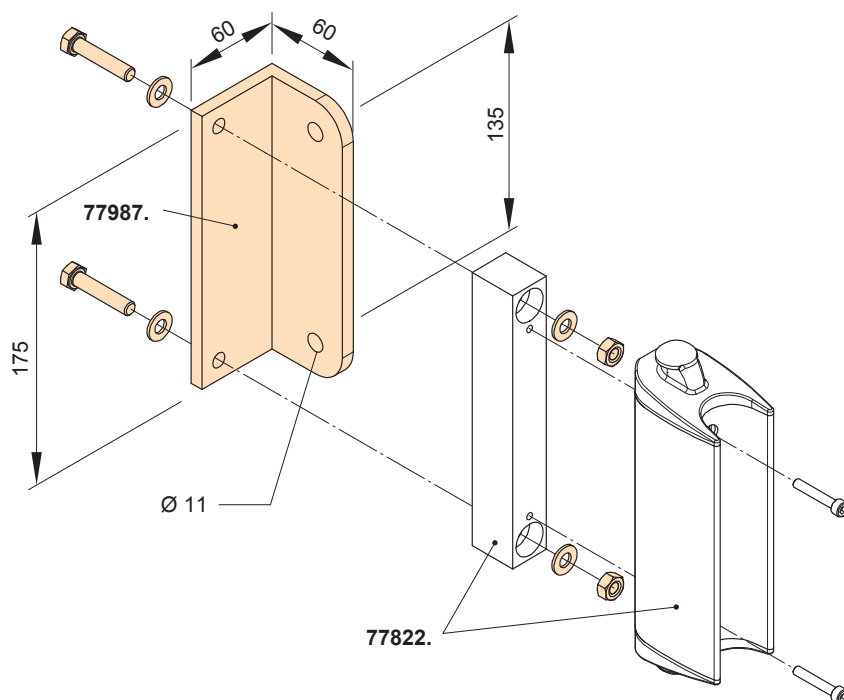
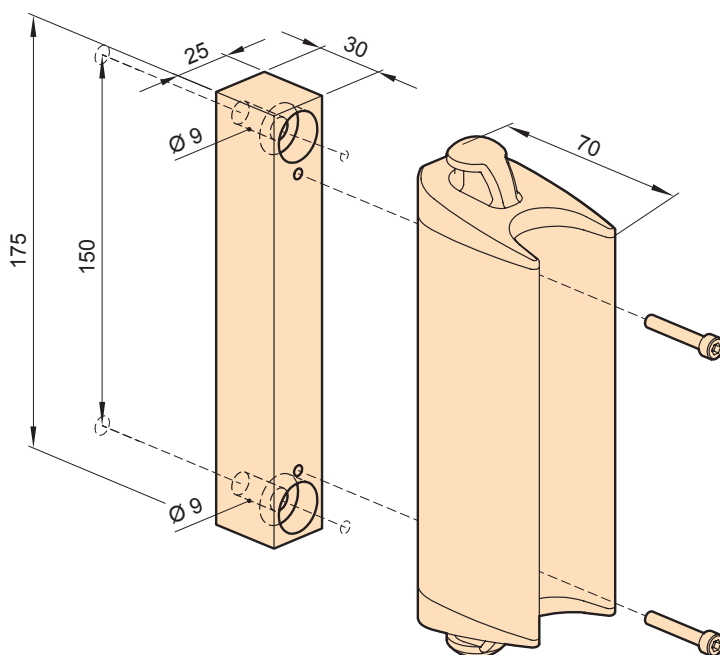

77987.



dimensions in mm

Docking post for front profile

Fixtures, fittings and accessories

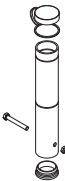
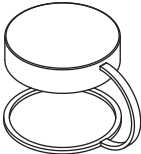
| | | |
|--|---|--|
|  <p>docking post assembly for the front profile</p> <p>with welded base plate</p> <p>77820.</p> |  <p>docking post assembly for the front profile</p> <p>for the ground sleeve</p> <p>77821.</p> |  <p>ground sleeve</p> <p>714501</p> |
|  <p>covering cap for the ground sleeve</p> <p>702851</p> | | |

Docking post with welded footplate (77820.)

With connecting profile and ground sleeve (77821.)

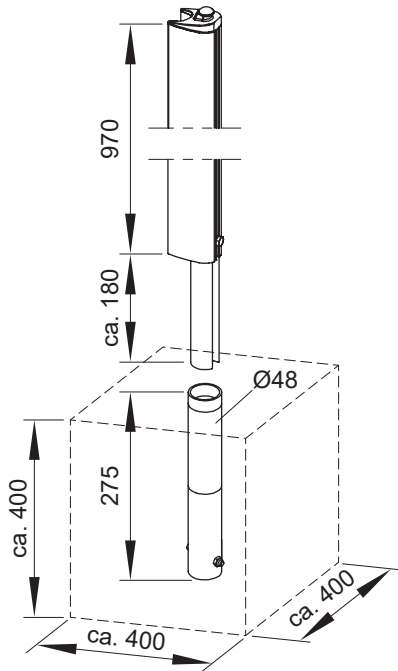
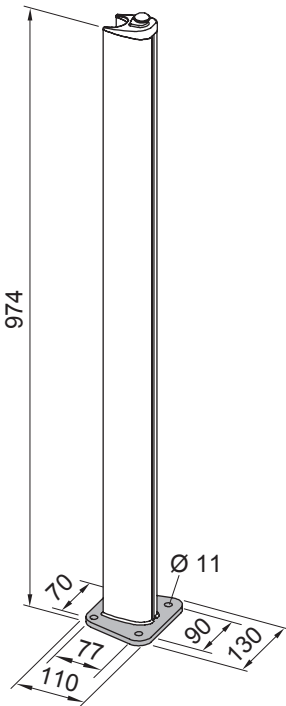

dimensions in mm

mobifix

Fixtures, fittings and accessories

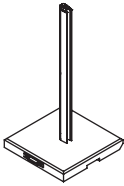

mobifix
docking post mounted
on a granite base
plate ¹⁾

approx. 40 kg

77821. | 778941 | 778931

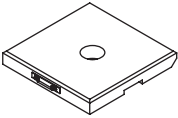

Additional granite slab
for the mobilfix
(recommended in light
wind) approx. 39 kg

with transport function

779311

1) Granite is a natural stone and can vary in colour and structure.
Note: The markilux mobilfix is only to be used up to a maximum screen height of **(GH)** 213 cm.

mobifix

mobifix with additional granite slab to weigh it down

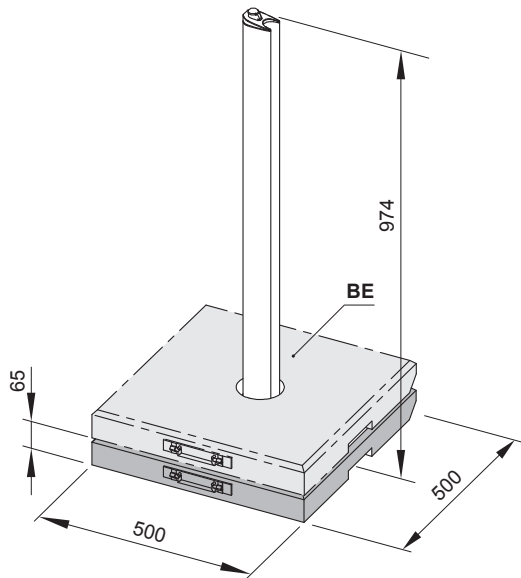
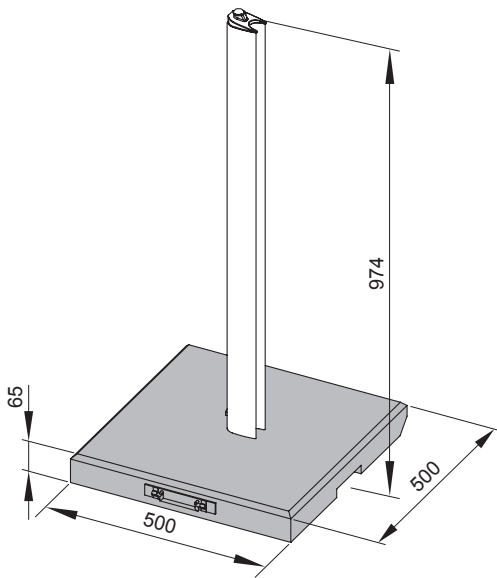

18 Transport function mobilfix

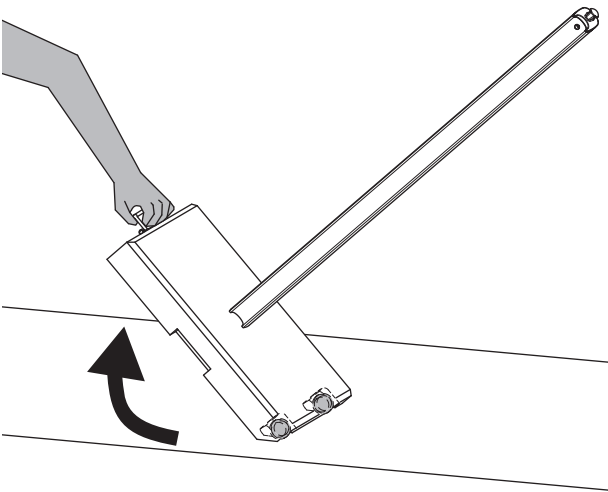

BE = additional granite slab to weigh it down (optional)

dimensions in mm

Docking bracket for front profile with clamp for fixture to a railing

Fixtures, fittings and accessories

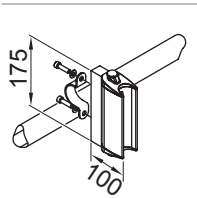
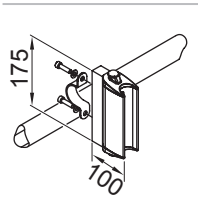
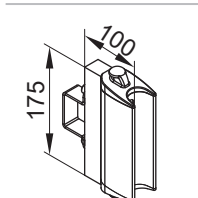
| | | |
|---|---|---|
|  <p>docking bracket for front profile with clamp for fixture to a railing Ø 40-45 mm</p> <p>77984.</p> |  <p>docking bracket for front profile with clamp for fixture to a railing Ø 45-50 mm</p> <p>77985.</p> |  <p>Railing bracket square post Ø 40-50 mm</p> <p>62433.</p> |
|---|---|---|

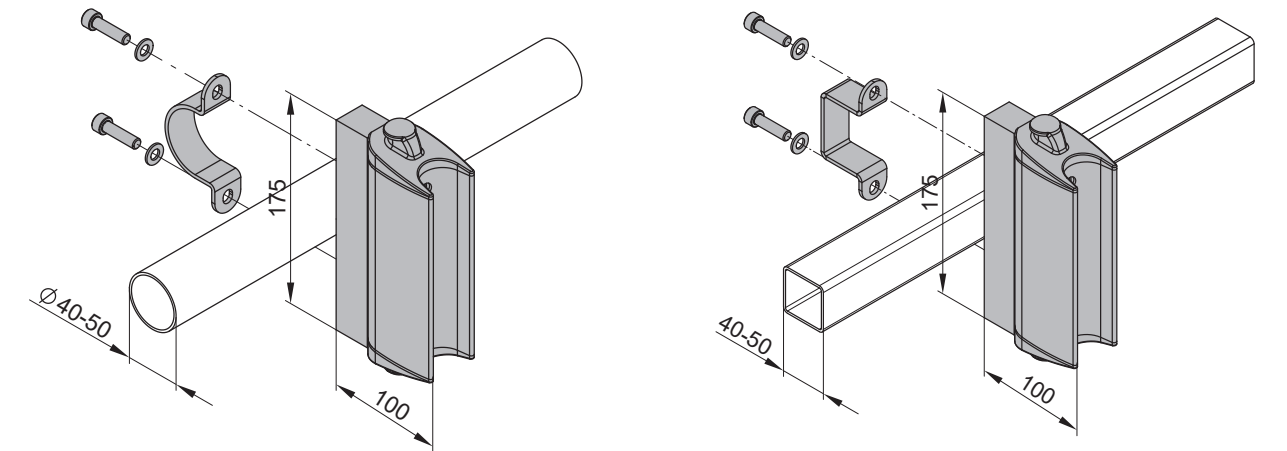

Railing bracket assembly for front profile

Fixtures, fittings and accessories

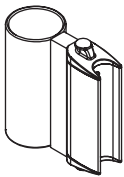

docking bracket for front profile
for markilux pergola
classic / cubic / compact
round posts

71136.

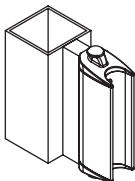
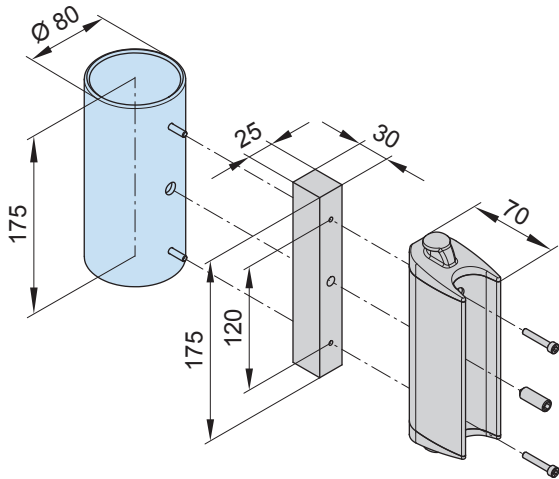

docking bracket for front profile
for markilux pergola /
pergola compact
square posts

75279.

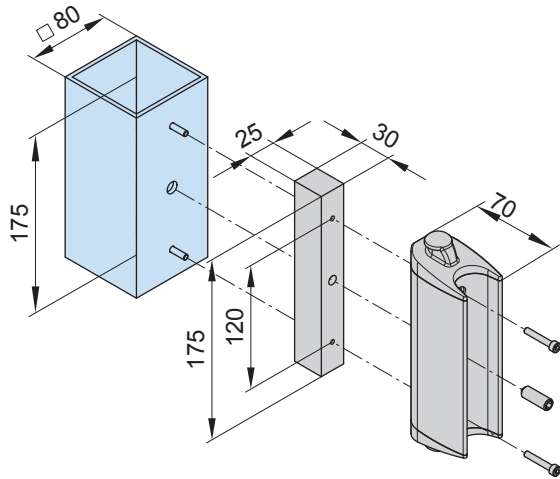

dimensions in mm

Cassette fixture to a post

Fixtures, fittings and accessories

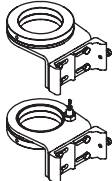
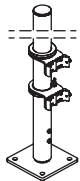
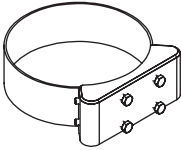
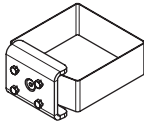
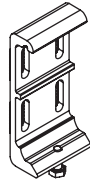
| | | | | | |
|---|--|---|---|---|--|
|  <p>71172.</p> | <p>post with base plate</p> <p>overall height adjustable from approx 1730–1830 mm, Ø 70 mm</p> |  <p>71174.</p> | <p>universal fixture bracket: for the post of the markilux pergola classic / cubic / compact, 2 pieces</p> <p>height approx. 80 mm, Ø 70 mm</p> |  <p>71175.</p> | <p>post 71172. including base plate 71174. fixture assembly for universal bracket for cassette overall height adjustable from approx 1730–1830 mm, Ø 70 mm</p> |
|  <p>72208.</p> | <p>post fixture for universal fixture bracket 78758. to the post of markilux syncra</p> <p>width 52 mm, for universal fixture bracket Ø 140 mm, for round post</p> |  <p>72231.</p> | <p>post fixture for universal fixture bracket 78758. to the post of markilux syncra</p> <p>width 52 mm, for square post 125 × 125 mm</p> |  <p>78758.</p> | <p>face fixture bracket 50 mm</p> |

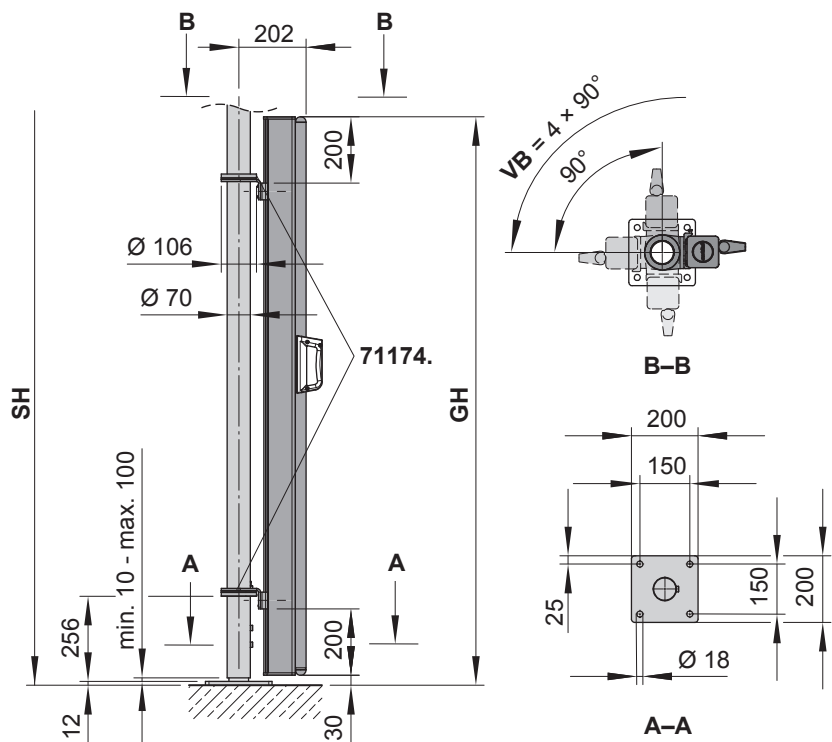

GH

=

order dimension

=

overall height

SH

=

support post height

VB

=

adjustment range (VB) of the fixture brackets with locking lever (4 × 90°)

dimensions in mm

Reveal fixture of the cassette

Fixtures, fittings and accessories

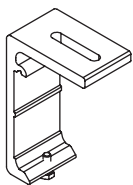

cassette bracket for
reveal fixture
50 mm

77845.

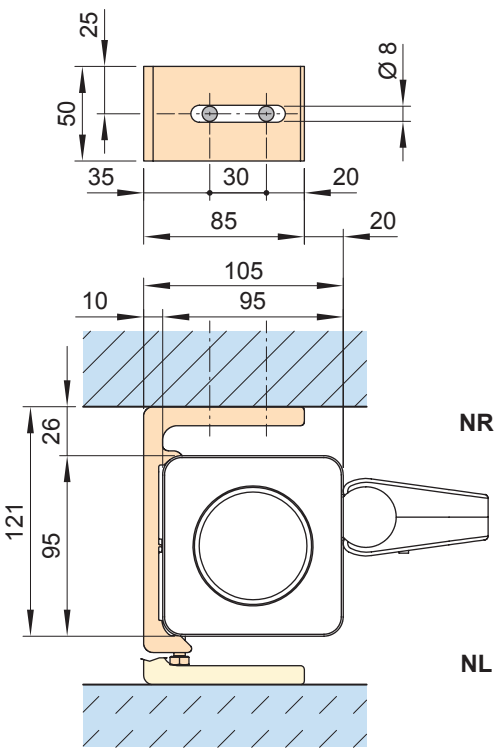

NR = reveal fixture right
NL = reveal fixture left

dimensions in mm